

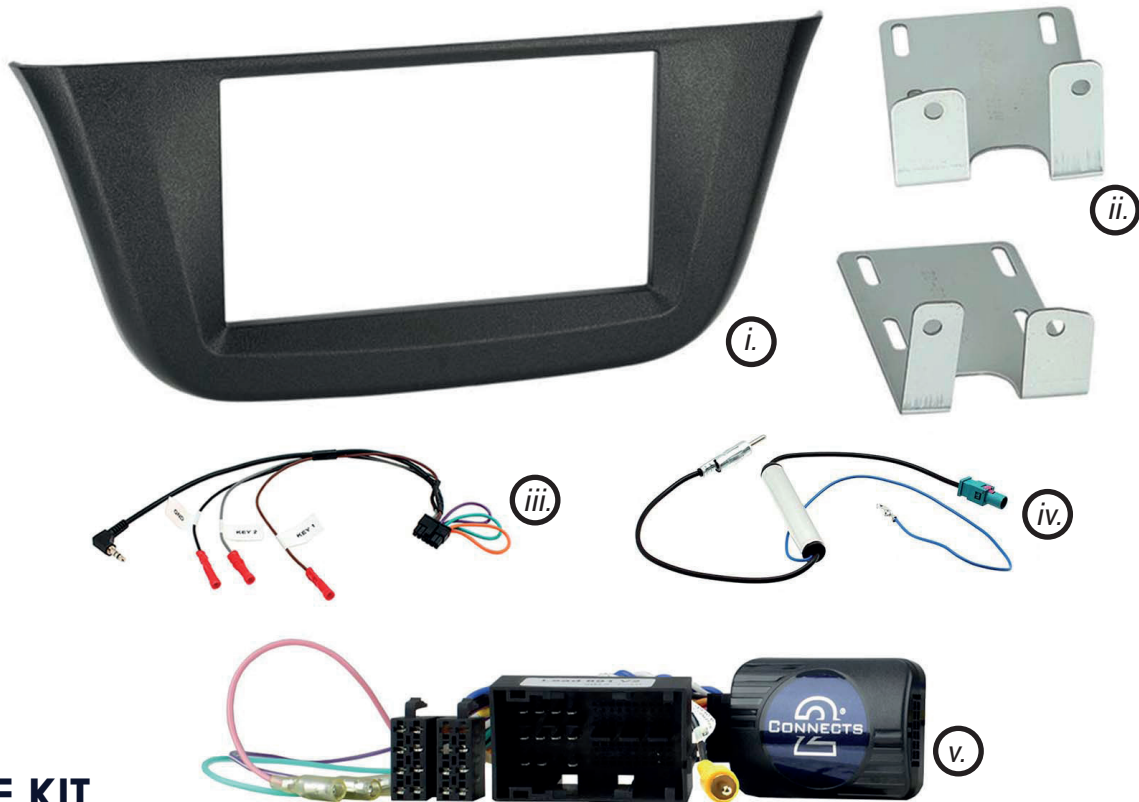

CTKIV02

Complete Installation Kit for Iveco Vehicles



IN THE KIT

- | | | | |
|------|-------------------------|-----|---------------------------|
| i. | Double DIN Fascia Panel | iv. | Fakra-DIN Antenna Adapter |
| ii. | Brackets | v. | SWC Interface/Harness |
| iii. | Universal Patch Lead | | |

Designed and
Engineered
in the UK. 

APPLICATION

Note: Application data is subject to change at any time

Iveco Daily 2020 >

Note: vehicle will need modification. Please familiarise yourself with the instructions before undertaking installation.

FEATURES

- Allows for the installation of a double DIN aftermarket stereo
- Includes mounting brackets and fitting accessories
- Retains factory steering wheel control functionality
- Retains factory phone buttons
- Retains factory reverse camera (if applicable)
- Provides outputs for speed pulse, reverse gear and park brake

DISCLAIMER

The information provided in this document is subject to change without notice due to manufacturer changes and/or improvements to the product/s. This instruction manual is based on documented data and research. The manufacturer of this product cannot be held responsible for any changes made to the vehicle by the manufacturer or damages that may occur through the installation of this product in accordance with the steps outlined herein.

PRODUCT INFORMATION

The **CTKIV02** is a complete installation kit that provides a solution for Iveco Daily vehicles when installing an aftermarket head unit. This kit contains a CAN steering wheel interface and harness which helps retain the steering wheel controls and factory phone button functionality of the vehicle (if vehicle is equipped). The harness also allows for the retention of the original reversing camera. The lead features plug-and-play connectors for an easier installation process.

Also provided is a vehicle specific antenna adapter, and a universal patch lead, to ensure compatibility with almost any head unit on the market.

WIRING KEY

IN ISO CONNECTOR

Purple	Right Rear Speaker +	Yellow	Permanent 12V
Purple/Black	Right Rear Speaker -	Black	Ground
Green	Left Rear Speaker +	Red	Ignition 12V
Green/Black	Left Rear Speaker -	Orange	Illumination
Grey	Right Front Speaker +		
Grey/Black	Right Front Speaker -		
White	Left Front Speaker +		
White/Black	Left Front Speaker -		

ADDITIONAL CONNECTIONS

Pink	Speed Pulse	Yellow RCA	Reverse Camera
Green	Park Brake		
Purple/White	Reverse Gear		

STEERING WHEEL CONTROL FUNCTIONALITY

The following diagram, though based on careful research, is an example only. Individual steering wheel control configurations may differ.

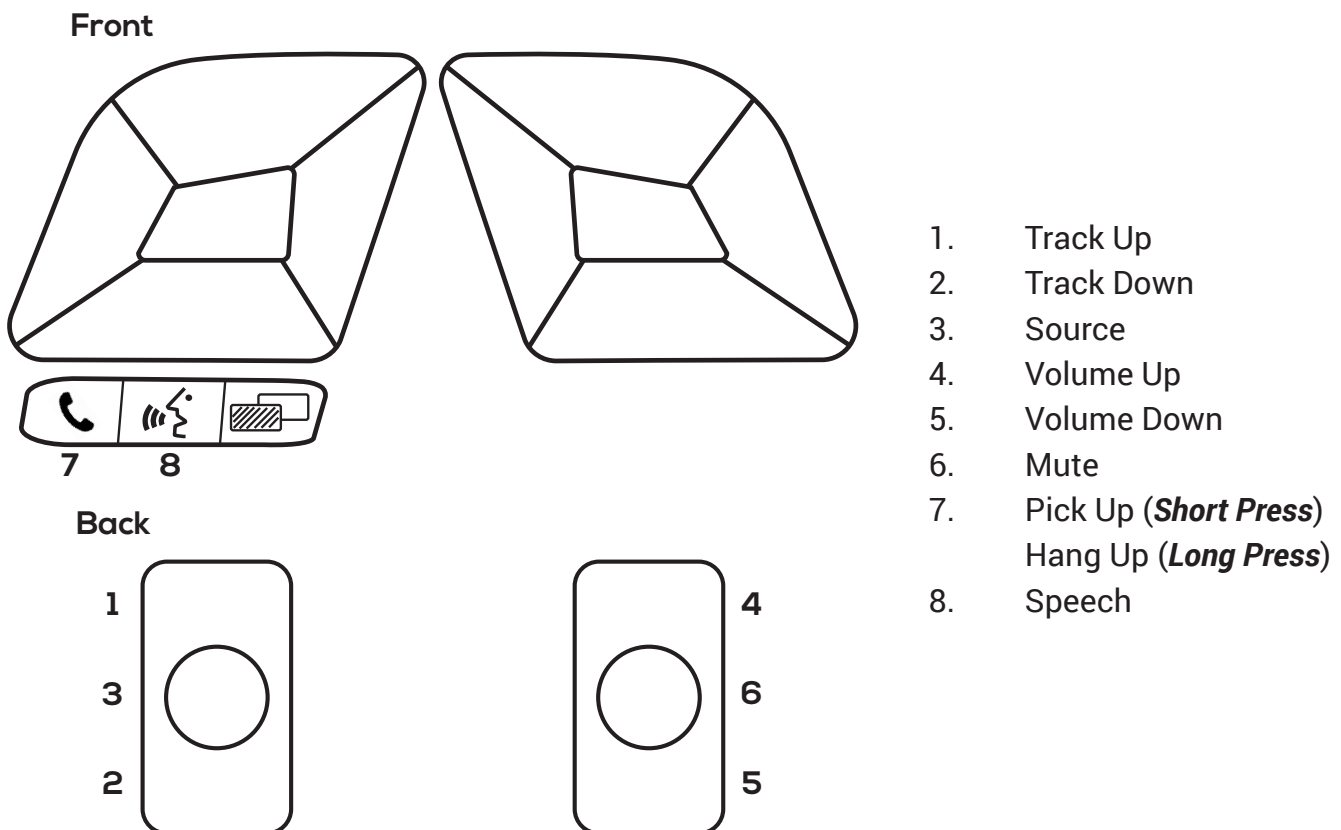

FASCIA DIAGRAM

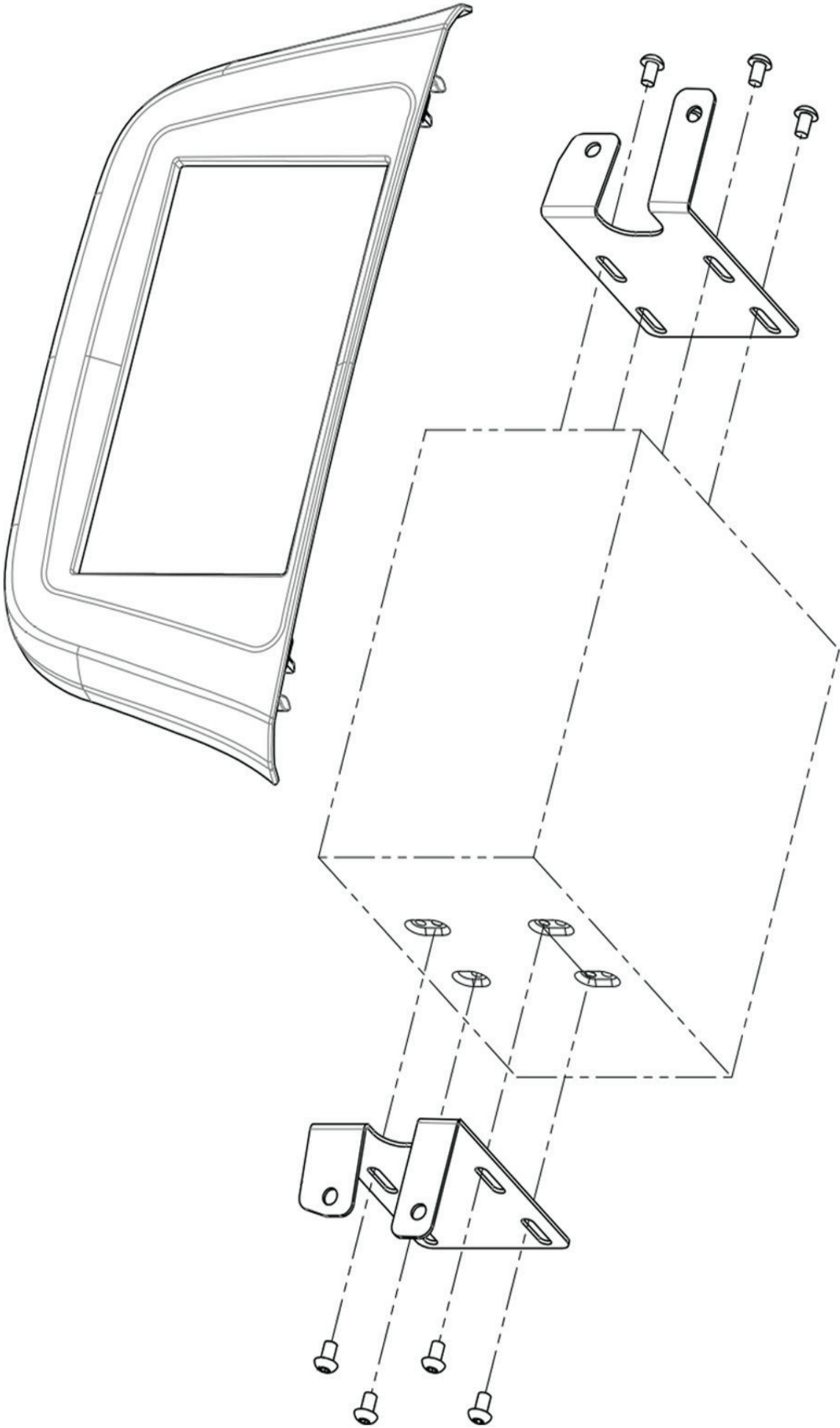

WIRING DIAGRAM

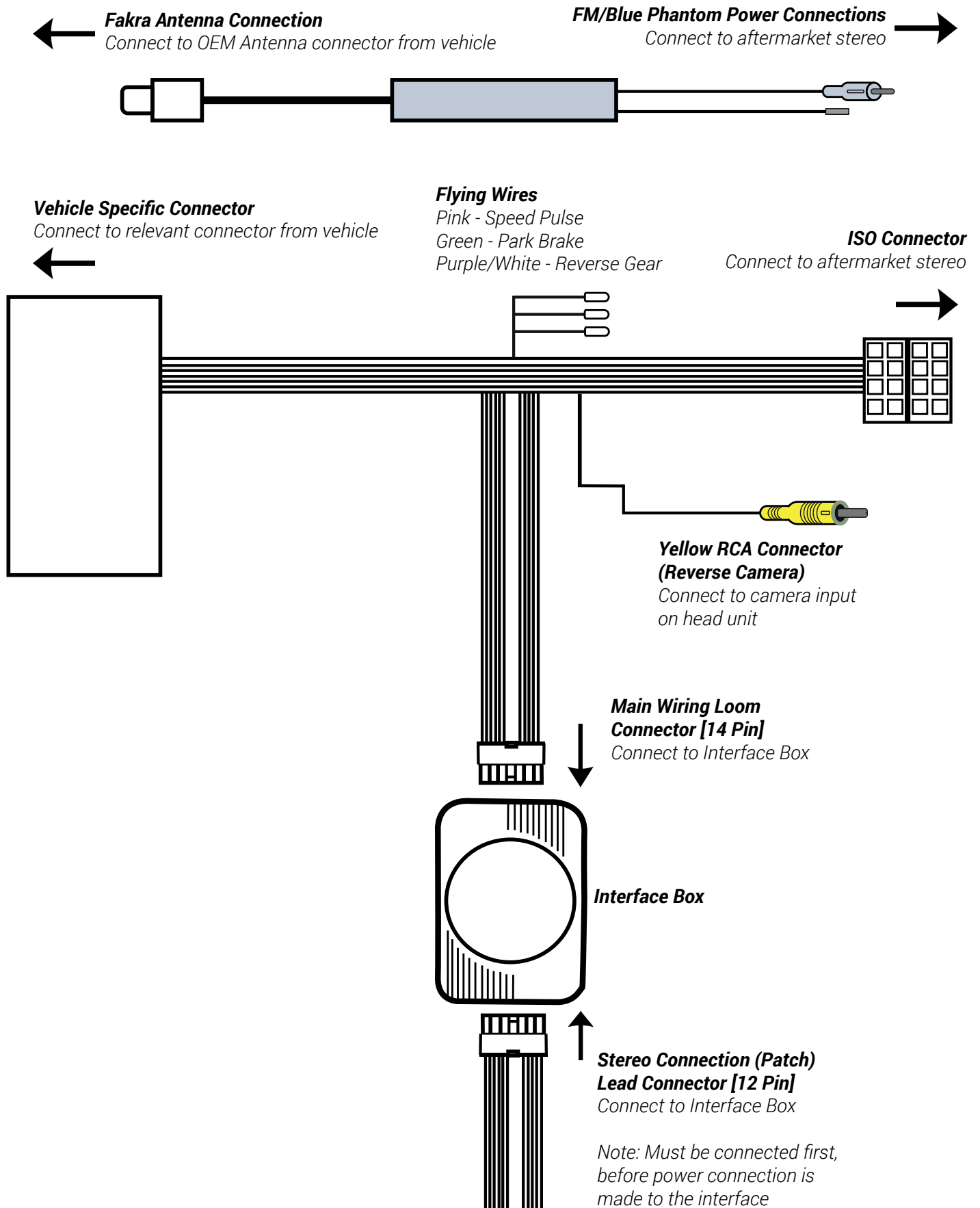

PRIOR TO INSTALLATION

Read the manual prior to installation. Technical knowledge is necessary for installation. The place of installation must be free of moisture and away from heat sources. Please ensure that the correct tools are used during the installation to avoid damage to the vehicle or product. **Connects2 can not be held responsible for the installation of this product.**

INSTALLATION GUIDE - FASCIA

DASH DISASSEMBLY

1.



Start by using a panel removal tool to remove the pocket from the front of the fascia.

If the trim level of the vehicle instead features a head unit, simply use a panel removal tool to unclip the fascia/radio combination and proceed to unclip all the connections.

Note: the following steps are for non-radio vehicles. See step 5 if radio is now out.

2.

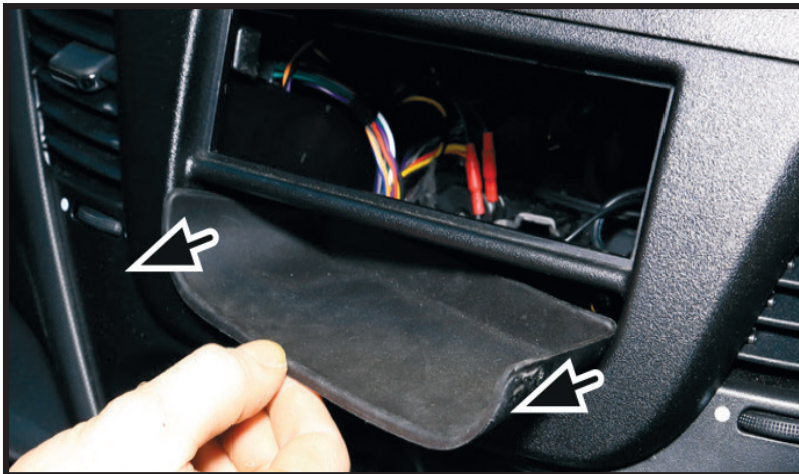

Just below the pocket will be an aperture with an anti-slip mat. This will be fixed in place with double-sided tape/glue. Pry this out of the dash.

3.

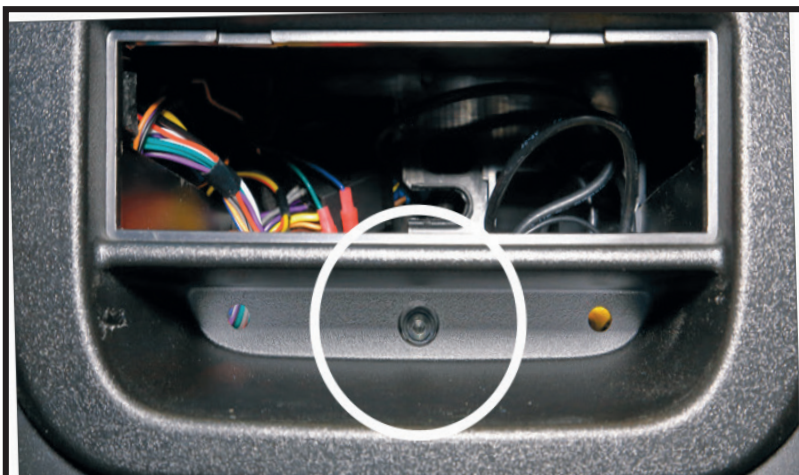

With the anti-slip mat out, this will reveal a single screw at the back of the pocket that will need to be removed.

Need help? Visit support.connects2.com/tickets/technical

INSTALLATION GUIDE

DASH DISASSEMBLY

4.

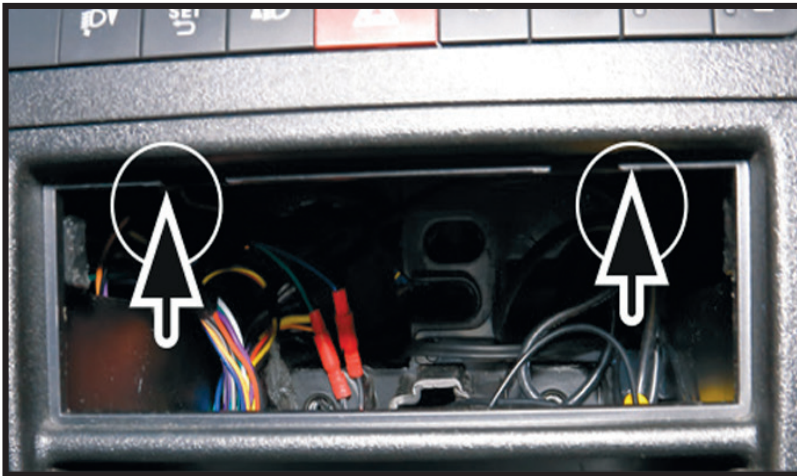

Proceed to then remove 2x screws that are located up within trim of the main fascia. Once undone, pull the fascia away from the dashboard.

DASHBOARD MODIFICATION

5.



The highlighted sections of the dashboard will need to be cut in order for the new head unit to sit in place correctly.

When performing any modification to the vehicle, always ensure to measure where the stereo will sit and take due care when performing modifications to the vehicle.

Connects2 always promotes the use and expertise of professional installers. Connects2 will not be held responsible for any damage to the vehicle.

BRACKET ASSEMBLY

6.

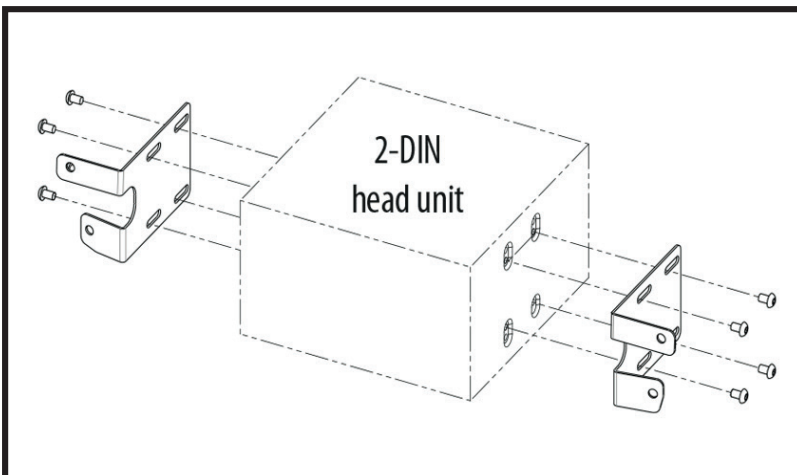

Take the brackets from the kit and attach them to the correct sides of the new head unit.

We recommend mounting roughly 19mm from the front of the head unit. Once attached, test fit the unit into the dashboard and adjust the fitting where necessary.

INSTALLATION GUIDE

DASH ASSEMBLY

7.

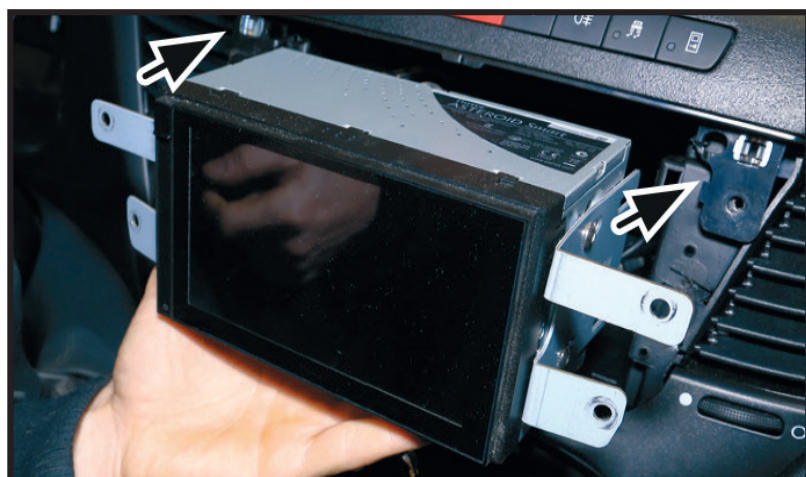

Once the head unit has been wired up correctly, proceed to slide the head unit into the dashboard. At this point, it would be best to test fit the stereo to ensure the wiring is correct.

8.



Once placed and happy with the fitment, screw into place using a set of screw (not supplied).

9.



With the head unit in place, proceed to fit the new fascia panel over the front of the radio to complete the installation.

INSTALLATION GUIDE - WIRING

See wiring diagram on Pg.4 for more information

Before installing the interface, the factory stereo must be removed and disconnected. To do this, please consult the vehicle owner's manual/handbook or contact a fitting professional.

For universal patch leads, prepare the wiring loops in accordance with the instruction manual supplied before installation.

1. Connect the 12 Pin connector from the stereo connection (patch) lead to the interface box.

2. Connect the opposite end of the stereo connection (patch) lead to the steering wheel control input on the back of the aftermarket stereo.

NOTE: This may be a 3.5mm jack connector or a wired input depending on the brand of aftermarket stereo being fitted. Please consult the aftermarket stereo installation manual for further information on where to make the connection.

! IMPORTANT: THIS STEP MUST BE COMPLETED BEFORE CONNECTING POWER TO THE INTERFACE. FAILURE TO DO SO MAY RESULT IN A LACK OF FUNCTIONALITY AND THE NEED TO REINSTALL THE PRODUCT.

3. Connect the 14 Pin connector from supplied wiring loom to the interface box.

4. Connect the power/speaker ISO connector to the power/speaker ISO connector at the rear of aftermarket stereo.

Note: For aftermarket stereos which do not have an ISO connector, please see 'Wiring Key' on Pg.2 for information on which wires to connect.

5. Connect any additional flying wires from the harness to the head unit as required.

Note: Additional 'flying' wires can be connected to the vehicle to support various features i.e. parking brake trigger, reverse gear and speed pulse. Details of these can be found under 'Additional Connections'.

6. Attach the antenna adapter in between the vehicles pre-existing connector as well as the rear of the aftermarket head unit.

NOTE: If vehicles which feature an amplified aerial, the blue wire will be needed for purposes of phantom power.

7. Attach the male yellow RCA connector to the reverse camera input of the aftermarket head unit.

8. Connect the vehicle specific connector to the vehicles main power connector.

9. Test stereo and steering wheel control functionality for correct operation before reassembling the vehicle dashboard. If steering wheel control functions are unresponsive, please uninstall the interface and wiring and reinstall carefully in accordance with the above steps.

***For further help, please contact and fill out a support ticket with the full details of your issue at:
support.connects2.com/tickets/technical***